

# APS Renovation / Redevelopment project

1 February 2019

Presentation for the NCCA

---

Major concerns raised by Arch. Gelo Manosa ON BEHALF OF  
National artist Francisco Manosa with reference to the 11 December  
2018 design of EPEA

1. Roof design [nipa hut / salakot / pitched roof]
2. Slanted windows
3. Banawe roof material
4. Finials

# APS Renovation / Redevelopment project

## 1 February 2019

---

### Presentation of the design

1. EPEA's revised design, 30 Jan. 2019 [comparison of existing vs. proposed design]
2. EPEA's alternative roof design [31 Jan. 2019] for Lopez/Rockwell corner to closely approximate the original design intent of Arch. Francisco Manosa. [design is a meter beyond height limitation]



# ATENEO PROFESSIONAL SCHOOLS ROCKWELL CAMPUS

GENERAL REMODELING

JANUARY 30, 2019

ARCHITECTS ESPINA, PEREZ-ESPINA,  
AND ASSOCIATES – MANILA

APS ROCKWELL CAMPUS  
GENERAL  
REMODELING

**FAÇADE**



# BEFORE AND AFTER HIDALGO COR LOPEZ DRIVE

# FACADE

ATENEO PROFESSIONAL SCHOOLS  
ROCKWELL CAMPUS



[https://upload.wikimedia.org/wikipedia/en/0/0d/Rockwell\\_Center\\_-\\_Ateneo\\_Professional\\_Schools\\_%28Guadalupe%2C\\_Makati%3B\\_2014-12-03%29.jpg](https://upload.wikimedia.org/wikipedia/en/0/0d/Rockwell_Center_-_Ateneo_Professional_Schools_%28Guadalupe%2C_Makati%3B_2014-12-03%29.jpg)

ATENEO PROFESSIONAL SCHOOLS  
ROCKWELL CAMPUS  
ACTUAL PHOTO



ATENEO PROFESSIONAL SCHOOLS - AFTER  
ROCKWELL CAMPUS  
PERSPECTIVE



PERSPECTIVE  
HIDALGO  
COR LOPEZ DRIVE





# DESIGN DETAILS

## FINIALS

Original finials will be located at the apex of each roof.



PERSPECTIVE  
HIDALGO  
COR LOPEZ DRIVE



# DESIGN DETAILS

## SLANTED WINDOWS

Windows of the additional floors will use the original design of windows of the existing floors below.



PERSPECTIVE  
HIDALGO  
COR LOPEZ DRIVE



# DESIGN DETAILS

## BANAWE ROOF

These new roofs will use the same material, Banawe Roofing Sheets, and slope as originally designed.

Note that Banawe Roofing Sheets minimum slope as per manufacturer is 21.26%.

PERSPECTIVE  
HIDALGO  
COR LOPEZ DRIVE





# DESIGN DETAILS

## LONG SPAN HI RIB ROOF

New roof in this area will use long span hi rib roofing sheets because of the required slope, 5%.

This roof will not be visible from the street.



PERSPECTIVE  
HIDALGO  
COR LOPEZ DRIVE



PERSPECTIVE  
HIDALGO DRIVE





PERSPECTIVE  
HIDALGO DRIVE



NEW BANAWE ROOF

NEW BANAWE ROOF



# PERSPECTIVE

## HIDALGO DRIVE

LONG SPAN  
HI RIB ROOF





# PERSPECTIVE

## HIDALGO DRIVE





# BEFORE AND AFTER ROCKWELL DRIVE

# FACADE

ATENEO PROFESSIONAL SCHOOLS  
ROCKWELL CAMPUS



ATENEO PROFESSIONAL SCHOOLS  
ROCKWELL CAMPUS  
ACTUAL PHOTO

[https://www.google.com.ph/url?sa=i&source=images&cd=&cad=rja&uact=8&ved=2ahUKEwjSpMzSk\\_TeAhVUXisKHQoSCJMQRx6BAGBEAU&url=http%3A%2F%2Fwww.wikiwand.com%2Fen%2FAteneo\\_Law\\_School&psig=AOvVaw37Z11EZ3jGpK1-f3ISTWak&ust=1543393673548277](https://www.google.com.ph/url?sa=i&source=images&cd=&cad=rja&uact=8&ved=2ahUKEwjSpMzSk_TeAhVUXisKHQoSCJMQRx6BAGBEAU&url=http%3A%2F%2Fwww.wikiwand.com%2Fen%2FAteneo_Law_School&psig=AOvVaw37Z11EZ3jGpK1-f3ISTWak&ust=1543393673548277)

ATENEO PROFESSIONAL SCHOOLS - AFTER  
ROCKWELL CAMPUS  
PERSPECTIVE





PERSPECTIVE  
ROCKWELL DRIVE





PERSPECTIVE  
ROCKWELL DRIVE





PERSPECTIVE  
ROCKWELL DRIVE





PERSPECTIVE  
ROCKWELL DRIVE





PERSPECTIVE  
ROCKWELL DRIVE





PERSPECTIVE  
ROCKWELL DRIVE



ROCKWELL DRIVE



# BEFORE AND AFTER ROCKWELL DRIVE COR RESIDENTIAL

# FACADE

ATENEO PROFESSIONAL SCHOOLS  
ROCKWELL CAMPUS



ATENEO PROFESSIONAL SCHOOLS  
ROCKWELL CAMPUS  
ACTUAL PHOTO  
<http://www.manosa.com/~manosa/teddy/images/2015-09-20-23-48-36---ateneoext.jpg>

ATENEO PROFESSIONAL SCHOOLS - AFTER  
ROCKWELL CAMPUS  
PERSPECTIVE





PERSPECTIVE  
ROCKWELL DRIVE COR  
RESIDENTIAL





PERSPECTIVE  
ROCKWELL DRIVE COR  
RESIDENTIAL





PERSPECTIVE  
ROCKWELL DRIVE COR  
RESIDENTIAL





PERSPECTIVE  
ROCKWELL DRIVE COR  
RESIDENTIAL





PERSPECTIVE  
ROCKWELL DRIVE COR  
RESIDENTIAL



LONG SPAN  
HI RIB ROOF



# BEFORE AND AFTER HIDALGO COR RESIDENTIAL

# FACADE

ATENEO PROFESSIONAL SCHOOLS  
ROCKWELL CAMPUS

ATENEO PROFESSIONAL SCHOOLS  
ROCKWELL CAMPUS  
ACTUAL PHOTO

<http://www.manosa.com/~manosa/teddy/project.php?architecture/institutional/ateneo-rockwell-rockwell-center-makati-city/&id=27>



ATENEO PROFESSIONAL SCHOOLS - AFTER  
ROCKWELL CAMPUS  
PERSPECTIVE





PERSPECTIVE  
HIDALGO DRIVE





PERSPECTIVE  
HIDALGO DRIVE





PERSPECTIVE  
HIDALGO DRIVE





# PERSPECTIVE

## HIDALGO DRIVE





# PERSPECTIVE

## HIDALGO DRIVE





# PERSPECTIVE HIDALGO DRIVE





FINIAL

BANAWE  
ROOF

SLANTED  
WINDOW

PLANTBOX







# ROOF PLAN

ATENEO PROFESSIONAL SCHOOLS  
ROCKWELL CAMPUS

ATENEO PROFESSIONAL SCHOOLS  
ROCKWELL CAMPUS  
EXISTING ROOF  
<https://www.google.com/maps/@14.5633226,121.0355188,142m/data=!3m1!1e3>

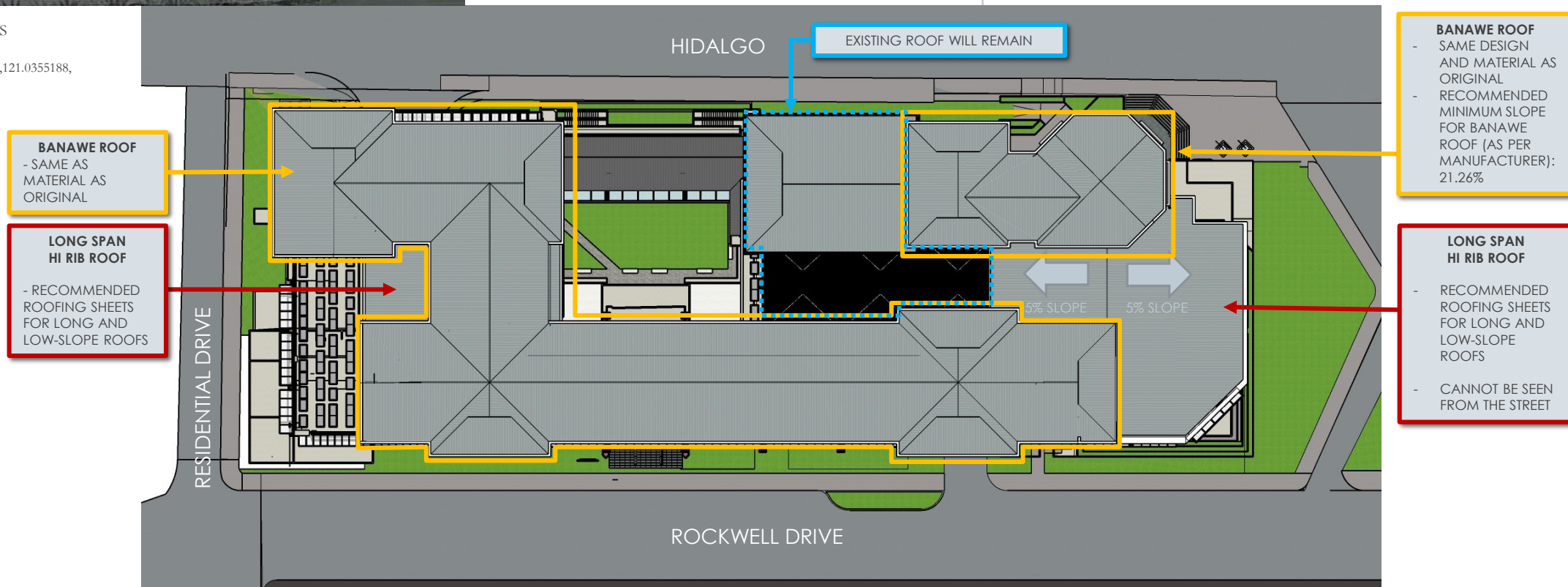



Alternative roof scheme for southeast corner to closely approximate the Manosa design  
[EPEA 31 Jan 2019]

Concern: The elevation is a meter higher than the approved height of the building. The APS will seek the approval of Rockwell Land Center.

---



Alternative roof scheme for southeast corner to closely approximate the Manosa design [EPEA 31 Jan 2019]





Alternative roof scheme for southeast corner to closely approximate the Manosa design [EPEA 31 Jan 2019]





Alternative roof scheme for southeast corner to closely approximate the Manosa design [EPEA 31 Jan 2019]





Alternative roof scheme for southeast corner to closely approximate the Manosa design [EPEA 31 Jan 2019]

